

# DRIVE OVER

---

BELT CONVEYOR



*Complimented by Comparison.*

# Drive Over Belt Conveyor

## Key Benefits

- Low drive-over clearance requires only 5-1/2" (14 cm) clearance.
- Extra wide 24" (61 cm) belt.
- Smooth transition from horizontal to incline.
- Optional greater discharge height.
- Higher capacity with lower belt speeds.
- PTO drive choices.
- Undercarriage lift choices.
- Receive from side dump wagons, as well as bottom dump and rear dump vehicles.
- S-type drive on return belt for greater drive efficiency and lower belt tension requirements. Includes snub pulley to give greater wrap at drive pulley for slip-free operation.
- Spring loaded belt take-up for lower operating belt tensions.
- Guide roller assembly to keep belt tracking properly.
- Removable hitch tube.
- Self cleaning wing type tail pulley.

## General Specifications

### INCLINED TROUGH:

### DRIVE:

### UNDERCARRIAGE (Standard):

### UNDERCARRIAGE (Optional):

### OPERATING BELT SPEED:

### CAPACITY:

### HORSEPOWER REQUIRED:

- Flat bottom, troughed edges, 10 gauge, 20 degree inclined angle.
- S-Drive on crescent face of belt w/spring loaded take-up, lagged drive pulley. Conveniently located under the incline section.
- Rotating arm design using a hydraulic cylinder.
- Rotating arm design using a screw jack for lift.
- 600-800 feet (183-244 m) per minute.
- Up to 10,000 bushels per hour (280 mth).
- 10 HP electric. Hydraulic drive capacity minimum 20 gal./min. @1500 PSI.

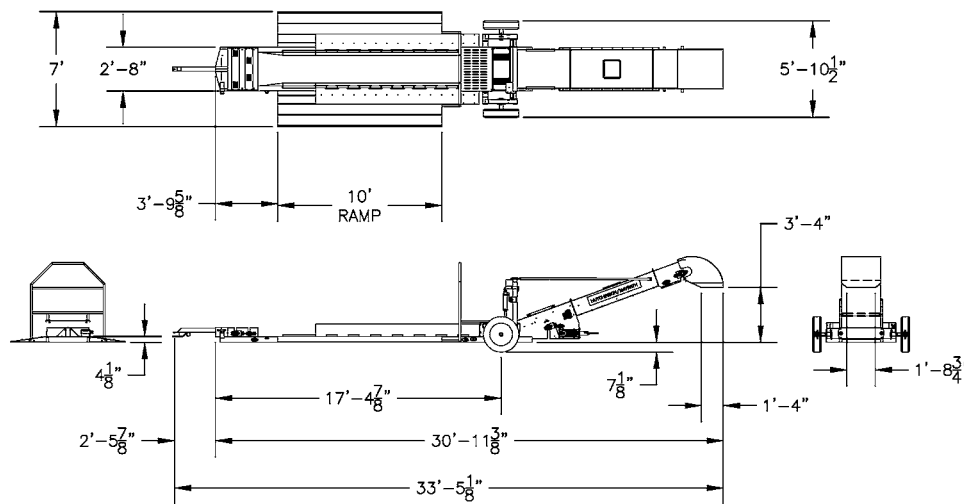

A Division of GLOBAL Industries, Inc.  
P.O. Box 629 • Clay Center, KS 67432  
Ph. (785) 632-2161 • FAX (785) 632-5964  
www.hutchweb.com

Call Toll-Free  
**1-800-523-6993**  
For more information.

Distributed by: